

Bramah / Joseph Wall Light - Small

BMW-14043 / JPW-14062 - UK/EU Ver
BMW-14875 / JPW-14877 - US Ver

Attention

In some countries electrical installation must be carried out by authorised electricians/ contractors; please check with your local authority for guidance.
The product must not be modified in any way. EOQ accepts no responsibility for any products that have been modified or tampered with.

If the trailing cable on this product becomes damaged it should be replaced immediately by qualified electrician to ensure there is no further danger to the user.

Cleaning Instructions

Ensure that the power supply has been turned OFF before cleaning the product. The product can be cleaned with a non-abrasive cloth.

Do not use alcohol or any other solvents to clean the product.

Technical Data

This product is supplied with an LED array. If one or more are defective, replace the whole LED module. Replacement LED module must be supplied by EOQ, please contact your local supplier/contractor for replacement.

Any LED used must comply with the recommended maximum voltage suggested on the safety label located on the product. This LED lamp is not dimmable.

EOQ will not accept any responsibility for any accidents or injury that occurs due to the use of incorrect LED.

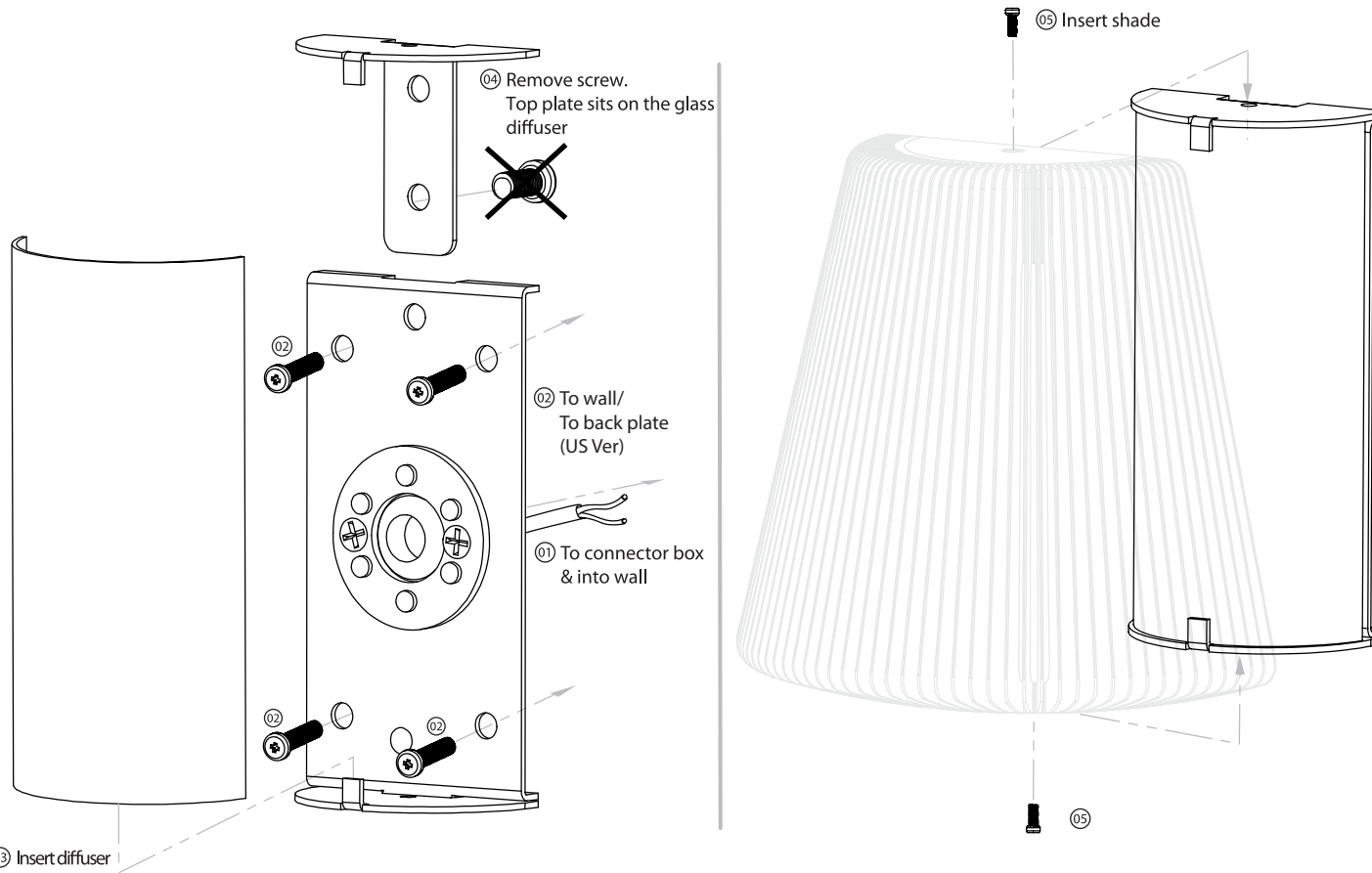

Designed by 03 Insert diffuser

Michael Young

www.eoq-design.com



Bramah Wall LED - Small BMW-14043



This luminaire contains built-in LED lamps

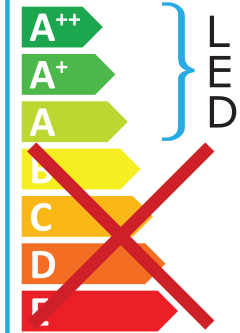

This lamp cannot be changed in the luminaire.

874/2012



Joseph Wall LED - Small JPW-14062



This luminaire contains built-in LED lamps

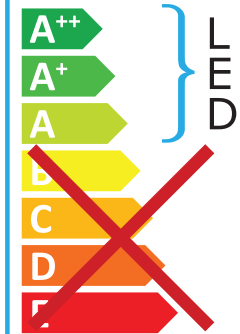

This lamp cannot be changed in the luminaire.

874/2012

